

FEATURES

- The diaphragm pulse valves are especially designed for dust collector service applications, combining high flow, long life and extremely fast opening and closing to produce reliable and economical operation
- The high flow, angle type bodies, springless construction, in combination with the special diaphragm assemblies give the unique operating features required for dust collector service applications
- Integral compression fittings for fast, easy, secure installation
- Built-in silencers guarantee noise free operation and avoid foreign particles entering the valve
- The integral operators are provided with epoxy moulded F-class coils. Various optional waterproof and explosionproof solenoids for use in potentially explosive atmospheres (gas & dust) according to Directive ATEX 2014/34/EU can be mounted on the same basic valve
- The components satisfy all relevant EC directives



GENERAL

Differential pressure (PS) 0,35 - 8,5 bar [1 bar = 100kPa]
Ambient temperature range -20 to +85°C

fluid (*)	temperature range (TS)	piston/diaphragm
air	-20 to +85 °C	TPE (thermoplastic polyester elastomer)
	-20 to +120 °C	FPM (fluoroelastomer)

CONSTRUCTION

(*) Ensure that the compatibility of the fluids in contact with the materials is verified

Body	Aluminium / Stainless steel 316L
Core tube	Stainless steel
Core and plugnut	Stainless steel
Core spring	Stainless steel
Sealings & disc	NBR (nitrile)
Diaphragm	TPE or FPM
Shading coil	Copper
Coil insulation class	F
Connector	Spade plug (cable Ø 6 - 10 mm), ISO 4400
Electrical safety	IEC 335

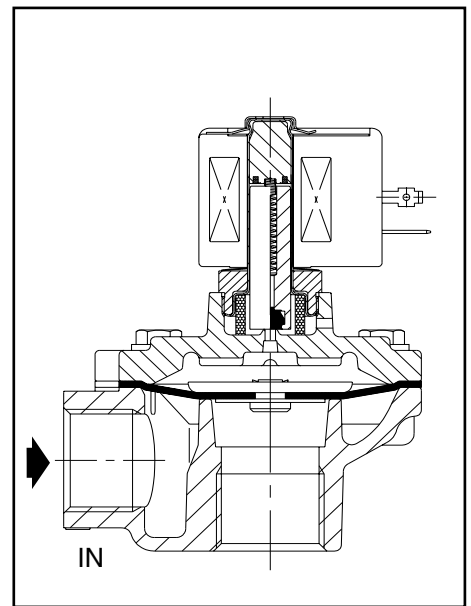

ELECTRICAL CHARACTERISTICS

Standard voltages DC (=) : 24V
 (Other voltages and 60 Hz on request) AC (~) : 24V - 115V - 230V / 50 Hz

coil type	Leistung				ambient temperature range (°C)	protection	replacement coil	
	inrush ~ (VA)	holding ~ (VA) (W)		hot/cold = (W)			~ 230 V/50 Hz	= 24 V DC
		(VA)	(W)					
CM6-FT	34	15,6	6	-	-20 to +85	IP65/IP67	400325-117	-
CM6-FT (1)	-	-	-	14 / 20,8			IP65/IP67	-

(1) Intermittent duty, Relative Duty Time is 10%. Max. on time is 1 min.

SPECIFICATIONS

pipe size	orifice size	flow coefficient Kv		operating pressure differential (bar)		prefix optional solenoids					catalogue number		FPM	
				min.	max. (PS)	ATEX					Aluminium	stainless steel AISI 316L		
G	(mm)	(m³/h)	(l/min)		air (*)	SC	WP	SG	EM (T)	NF				
(G) - Threaded pipe connection														
3/4	25	14	233	0,35	8,5	●	●	●	●	●		G353A043	G353D132	V
1	25	17	283			●	●	●	●	●			G353A044	G353D133
Ø - Compression fitting pipe connection														
3/4	25	14	233	0,35	8,5	●	●	●	●	●		G353-052	-	V
1	25	17	283			●	●	●	●	●			G353-053	-

● : available feature

OPTIONS

- Waterproof enclosure with embedded screw terminal coil according to protection class IP67, CEE 10
- Explosionproof solenoids for hazardous locations according to "ATEX" and national standards
- IECEX certification
- Plug with visual indication and/or peak voltage suppression
- Electronic timer
- Valves can also be supplied with FPM (fluorelastomer) diaphragm and seal materials. Use the appropriate optional suffix letter for identification

INSTALLATION

- The valves can be mounted in any position without affecting operation
- Pipe connection identifier is: G = G (ISO 228/1) or compression fitting
- For compression fitting types tightness is achieved by the compressed gasket on the blow tube
- The use of the rubber gaskets as sealing members will allow a slight misalignment in piping when using compression fittings
- Other pipe threads are available on request
- Installation/maintenance instructions are included with each valve
- Spare parts kit and replacement coils on request

DIMENSIONS (mm), WEIGHT (kg)

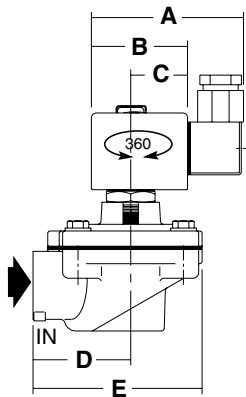

Fig. 1 threaded type

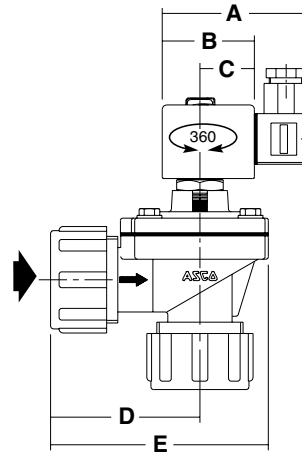
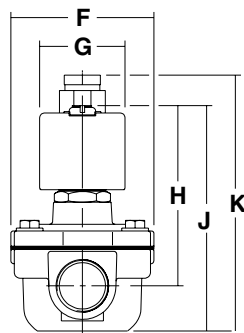

Fig. 2 compression fitting type

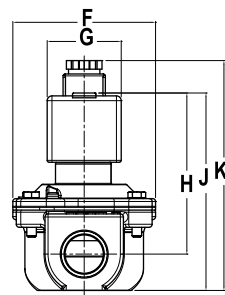
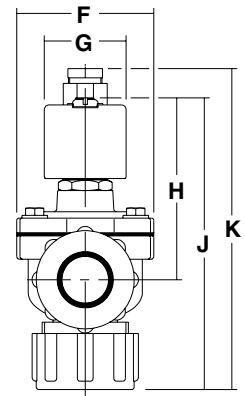
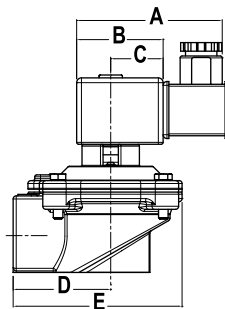

Fig. 3: threaded type - Stainless steel



catalogue number	A	B	C	D	E	F	G	H	J	K	weight (1)	(C)
SC G353A043	75	45	27	51	89	75	39	92	113	130	0,70	Abb. 1
SC G353A044	75	45	27	51	89	75	39	92	113	130	0,65	Abb.1
SC G353-052	75	45	27	81	125	75	39	92	175	195	0,85	Abb. 2
SC G353-053	75	45	27	81	125	75	39	92	175	195	0,90	Abb. 2
SC G353D132	89	57	31	51	89	75	50	93	117	130	1,30	Abb. 3
SC G353D133	89	57	31	51	89	75	50	96	117	130	1,20	Abb. 3
Atex II3D												
SG G353A043	89	57	31	51	89	75	50	92	113	130	0,70	Abb. 3
SG G353A044	89	57	31	51	89	75	50	92	113	130	0,65	Abb.3
SG G353-052	89	57	31	81	125	75	50	92	175	195	0,85	Abb. 2
SG G353-053	89	57	31	81	125	75	50	92	175	195	0,90	Abb. 2

(1) including coil and connector (prefix SC or SG)

(C) construction type

SPARE PARTS KITS

catalogue number	spare parts kit no. ~/=
SC G353A043	C113444
SC G353A044	
SC G353-052	
SC G353-053	
SG G353A043	
SG G353A044	
SG G353-052	
SG G353-053	

PULSE VALVES

dual stage, integral pilot
threaded body 1 1/2 to 3 or
compression fitting Ø 1 1/2

FEATURES

- The diaphragm pulse valves are especially designed for dust collector service applications, combining high flow, long life and extremely fast opening and closing to produce reliable and economical operation
- Integral compression fittings for fast, easy, secure installation
- The high quality diaphragms are reinforced and wear resistant to guarantee a long operating life, even under harsh conditions
- The integral operators are provided with epoxy moulded F-class coils. Various optional waterproof and explosionproof solenoids for use in potentially explosive atmospheres (gas & dust) according to Directive ATEX 2014/34/EU can be mounted on the same basic valve
- The valves satisfy all relevant EC directives

GENERAL

Differential pressure (PS) 0,35 - 8,5 bar [1 bar = 100kPa]
Ambient temperature range -20 to +85°C

fluids (*)	temperature range (TS)	diaphragm (*)
air	-20 to +85 °C	CR (chloroprene)
	-20 to +120 °C	FPM (fluoroelastomer)

MATERIALS IN CONTACT WITH FLUID

(*) Ensure that the compatibility of the fluids in contact with the materials is verified

Body Aluminium / Stainless steel 316L
Core tube Stainless steel
Core and plugnut Stainless steel
Core spring Stainless steel
Sealings & disc NBR (nitrile)
Diaphragm CR or FPM
Shading coil Copper
Coil insulation class F
Connector Spade plug (cable Ø 6 - 10 mm)
Connector specification ISO 4400
Electrical safety IEC 335

ELECTRICAL CHARACTERISTICS

Standard voltages DC (=) : 24V
 (Other voltages and 60 Hz on request) AC (~) : 24V - 115V - 230V / 50 Hz

coil type	nominal power ratings				operator temperature range (TS) (°C)	protection	replacement coil	
	inrush ~ (VA)	holding ~ (VA) (W)		hot/cold = (W)			~ 230 V/50 Hz	= 24 V DC
		10,5	14 / 19,7					
CMXX-FT	55	23	10,5	-	-20 to +85	IP65	-	-
CMXX-FF	-	-	-	-	-	-	-	-

SPECIFICATIONS

pipe size	orifice size	flow coefficient Kv		operating pressure differential (bar)		prefix optional solenoids					catalogue number		FPM
				min.	max. (PS)	ATEX		aluminium		stainless steel 316L			
G	(mm)	(m³/h)	(l/min)		air (*)	SC	WP	SG	EM (T)	NF			
G - Threaded pipe connection													
1 1/2	50	44	733	0,35	8,5	●	●	●	●	●	G353A047 ⁽¹⁾	G353D134 ⁽¹⁾	V
2	66	77	1290	0,35	8,5	●	●	●	●	●	G353A050 ⁽¹⁾	-	V
2 1/2	66	92	1540	0,35	8,5	●	●	●	●	●	G353A051 ⁽¹⁾	-	V
3	76	170	2833	1	6	●	●	●	●	●	G353D060 ⁽¹⁾⁽²⁾	-	V
Ø - Compression fitting pipe connection													
1 1/2	52	44	733	0,35	8,5	●	●	●	●	●	G353A065 ⁽¹⁾	-	V

● : Available feature

(1) Contains spring above the main diaphragm

(2) Threaded pipe connection is external (male thread)

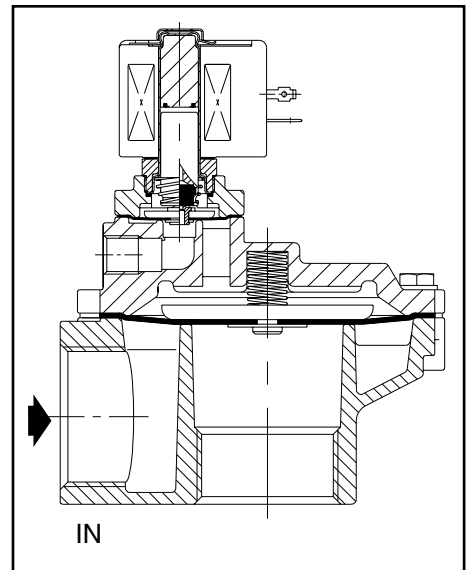

OPTIONS

- Waterproof enclosure with embedded screw terminal coil according to protection class IP67, CEE 10
- Explosionproof solenoids for hazardous locations according to ATEX and national standards
- **IECEX** certification
- Hose connection executions (3" only)
- Plug with visual indication and/or peak voltage suppression
- Electronic timer
- Valves can also be supplied with FPM (fluoroelastomer) diaphragms and seals. Use the appropriate optional suffix letter for identification

INSTALLATION

- The valves can be mounted in any position without affecting operation
- Threaded pipe connection is G (ISO 228/1) or compression fitting
- For compression fitting types tightness is achieved by the compressed gasket on the blow tube
- The use of the rubber gaskets as sealing members will allow a slight misalignment in piping when using compression fittings
- Other pipe threads are available on request
- Installation/maintenance instructions are included with each valve
- Spare parts kits and replacement coils are available

DIMENSIONS (mm), WEIGHT (kg)

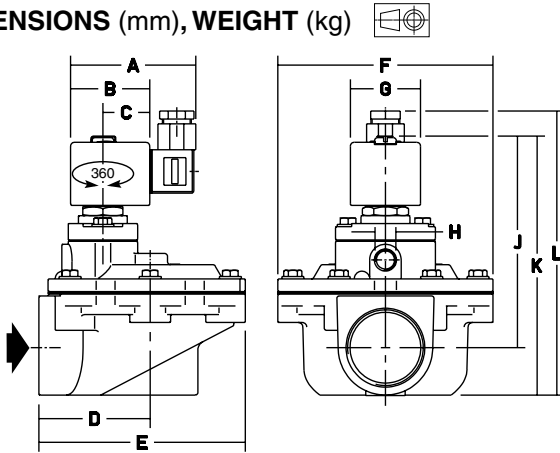

Fig. 1: Threaded pipe connection - aluminium

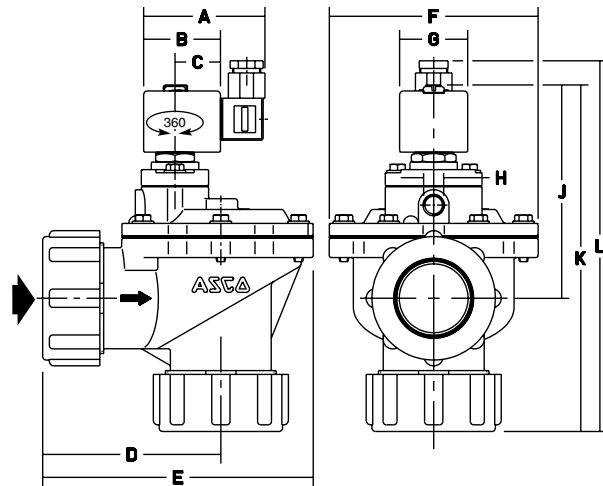

Fig. 2: Compression type fitting - aluminium

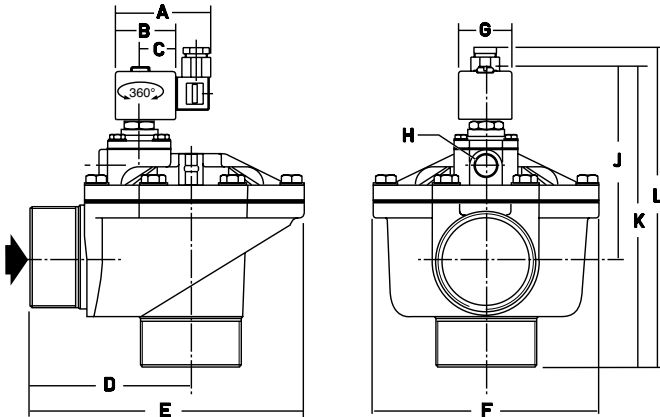

Fig. 3: External threaded type - aluminium

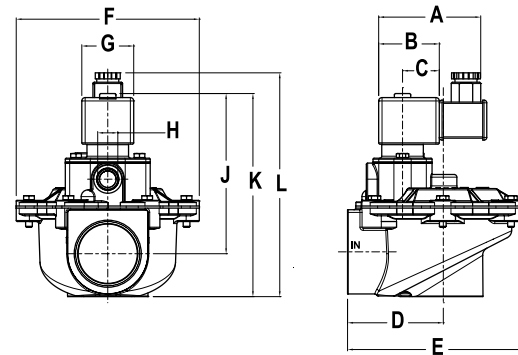

Fig. 4: Threaded pipe connection - stainless steel

catalogue number	A	B	C	D	E	F	G	H	J	K	L	weight (1)	(C)
SC G353A047	80	50	30	71	130	136	45	G3/8	131	161	178	1,40	Fig. 1
SC G353A050	80	50	30	95	168	165	45	G3/4	165	210	227	2,90	Fig. 1
SC G353A051	80	50	30	95	168	165	45	G3/4	165	210	227	2,60	Fig. 1
SC G353D060	89	57	31	143	240	193	50	G1/2	165	257	271	4,10	Fig. 3
SC G353A065	80	50	30	117	177	136	45	G3/8	131	225	242	1,75	Fig. 2
SC G353D134	89	57	31	71	130	136	50	G3/8	132	162	174	2,50	Fig. 4
Atex II3D													
SG G353A047	89	57	31	71	130	136	50	G3/8	131	161	174	1,40	Fig. 1
SG G353A050	89	57	31	95	168	165	50	G3/4	165	210	222	2,90	Fig. 1
SG G353A051	89	57	31	95	168	165	50	G3/4	165	210	222	2,60	Fig. 1
SG G353A065	89	57	31	117	177	136	50	G3/8	131	225	238	1,75	Fig. 2

(1) Incl. coil and connector (prefix SC or SG) (C) construction type

All leaflets are available on: www.asconumatics.eu

SPARE PARTS KITS

catalogue number	Spare parts kit no.	
	~	=
SC G353A047	C113827	C113827
SG G353A065		
SC G353A050	C113685	C113686
SC G353A051		
SC G353D060		

PULSE VALVES

single stage, remote pilot
threaded body or compression fitting
3/4 to 1 1/2

FEATURES

- The diaphragm pulse valves are especially designed for dust collector service applications, combining high flow, long life and extremely fast opening and closing to produce reliable and economical operation
- The high flow, angle type bodies in combination with the special main diaphragm assemblies give the unique operating features required for dust collector service applications
- Integral compression fittings for fast, easy, secure installation
- Valves can be supplied according to ATEX Directive 2014/34/EU for non-electrical equipment
- The valves satisfy all relevant EC directives

GENERAL

Differential pressure (PS) 0,35 - 8,5 bar [1 bar = 100kPa]
Ambient temperature range -20 to +85°C

fluids (*)	temperature range (TS)	diaphragm (*)
air	-40 to +85 °C	TPE (3/4 and 1)
	-20 to +85 °C	CR (1 1/2)
	-20 to +120 °C	FPM

MATERIALS IN CONTACT WITH FLUID

(*) Ensure that the compatibility of the fluids in contact with the materials is verified

Body Aluminium / Stainless steel 316L
Spring Stainless steel
Diaphragm TPE (thermoplastic polyester elastomer or CR (chloroprene) or FPM (fluoroelastomer)

PILOT SOLENOID VALVES (2/2 NC function)

main pulse valve catalogue number	remote pilot connection	recommended executions		
		orifice size (mm)	manifold pilot valves in a box (IP 65)	single pilot valves (IP20)
G353A041	G 1/8	3,6	pilot box series 110 2 to 12 pilots 1/8	series 257
G353-055				
G353A042				
G353-056				
G353A045	G 1/4	5,6	pilot box series C20 4 to 6 valves 1/4	series 262
G353-066				

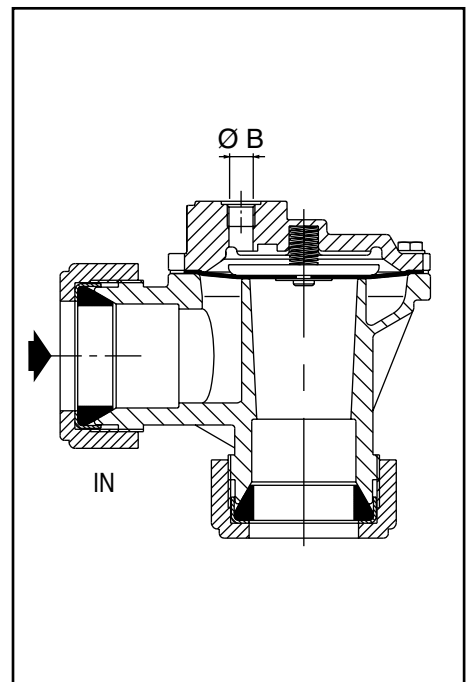

SPECIFICATIONS

pipe size	remote pilot connection	orifice size	flow coefficient Kv		operating pressure differential (bar)		catalogue number		FPM	
					min.	max. (PS) air (*)				
G	Ø B	(mm)	(m³/h)	(l/min)	-/=		aluminium ⁽¹⁾	stainless steel 316L		
G - threaded pipe connection										
3/4	G 1/8	24	14	233	0,35	8,5	G353A041 (GD)	G353A130	V	
1	G 1/8	27	17	283	0,35	8,5	G353A042 (GD)	G353A131	V	
1 1/2	G 1/4	52	46	768	0,35	8,5	G353A045 (GD)	-	V	
Ø - Compression fitting pipe connection										
3/4	G 1/8	24	14	233	0,35	8,5	G353-055 (GD)	-	V	
1	G 1/8	27	17	283	0,35	8,5	G353-056 (GD)	-	V	
1 1/2	G 1/4	52	43	717	0,35	8,5	G353-066 (GD)	-	V	

(1) Suffix GD for ATEX II2G/D

60153GB-2016/R01 Availability, design and specifications are subject to change without notice. All rights reserved.

OPTIONS

- Valves can also be supplied with FPM (fluoroelastomer) diaphragms and seals. Use the appropriate optional suffix letter for identification
- Sequential controller for pilot solenoid valves
- Pilot boxes containing 2 to 12 pilot solenoid valves
- Pilot solenoid valves can be equipped with explosionproof solenoids for hazardous locations according to “ATEX” and national standards

INSTALLATION

- The valves can be mounted in any position without affecting operation
- Threaded pipe connection is G (ISO 228/1) or compression fitting
- When connecting piping or tubing to the G1/8 connection in the valve bonnet, the remote ASCO pilot valve should be mounted as close as possible to the main pulse valve. Connection tubing lengths of 3 meter or less have little effect on the pulse response. Installations with over 3 meter of tubing must be tested under actual operating conditions. Tubing with Ø 6 mm O.D. is recommended for all installations
- For compression fitting types tightness is achieved by the compressed gasket on the blow tube
- Other pipe threads are available on request
- Installation/maintenance instructions are included with each valve
- Spare parts kits and replacement coils are available

DIMENSIONS (mm), WEIGHT (kg)

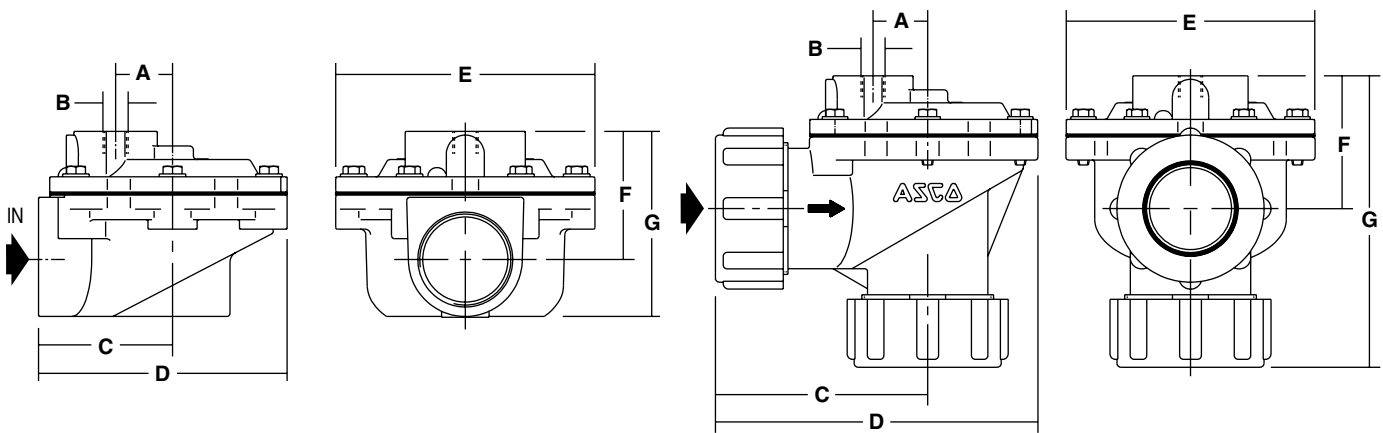

Fig. 1: Threaded pipe connection - aluminium

Fig. 2: Compression type fitting - aluminium

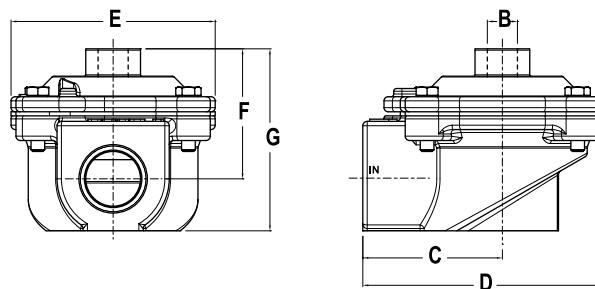

Fig. 3: Threaded pipe connection - Stainless steel

catalogue number	A	B	C	D	E	F	G	weight	(C)
G353A041 (GD)	-	G 1/8	51	89	75	41	65	0,45	Fig. 1
G353A042 (GD)	-	G 1/8	51	89	75	41	64	0,4	Fig. 1
G353A045 (GD)	30	G 1/4	71	130	136	71	98	1	Fig. 1
G353-055 (GD)	-	G 1/8	88	125	75	47	109	0,58	Fig. 2
G353-056 (GD)	-	G 1/8	88	124	75	47	129	0,61	Fig. 2
G353-066 (GD)	30	G 1/4	117	177	136	73	161	1,33	Fig. 2
G353A130 (GD)	-	G 1/8	51	89	75	41	64	0,92	Fig. 3
G353A131 (GD)	-	G 1/8	51	89	75	41	64	0,87	Fig. 3

(C) Construction type

SPARE PARTS KITS

catalogue number	spare parts kit no. ~/=
G353A041 (GD)	C113443
G353A042 (GD)	
G353-055 (GD)	
G353-056 (GD)	
G353A045 (GD)	C113825
G353-066 (GD)	

PULSE VALVES

dual stage, remote pilot
threaded body 1 1/2 to 3 or
compression fitting Ø 1 1/2

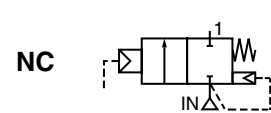

FEATURES

- The pulse valves are especially designed for dust collector service applications, combining high flow, long life and extremely fast opening and closing to produce reliable and economical operation
- The high flow, angle type bodies in combination with the special main diaphragm assemblies give the unique operating features required for dust collector service applications
- Integral compression fittings for fast, easy, secure installation
- Valves can be supplied according to ATEX Directive 2014/34/EU for non-electrical equipment
- The components satisfy all relevant EC directives

GENERAL

Differential pressure (PS) 0,35 - 8,5 bar [1 bar = 100kPa]
Ambient temperature range -20 to +85°C

fluids (*)	temperature range (TS)	diaphragm (*)
air	-20 to +85 °C	CR (chloroprene)
	-20 to +120 °C	FPM (fluoroelastomer)

CONSTRUCTION

Body Aluminium
Springs Stainless steel
Diaphragms CR or FPM

PILOT SOLENOID VALVES (2/2 NC function)

main pulse valves	remote pilot connection	recommended executions		
		orifice size (mm)	manifold pilot valves in a box (IP65)	single pilot valves (IP20)
G353A046 G353A063	G1/8	3,6	pilot box series 110 2 to 12 valves 1/8	series 257
G353A048 G353A049 G353.058	G1/4	5,6	pilot box series C20 4 to 6 valves 1/4	series 262

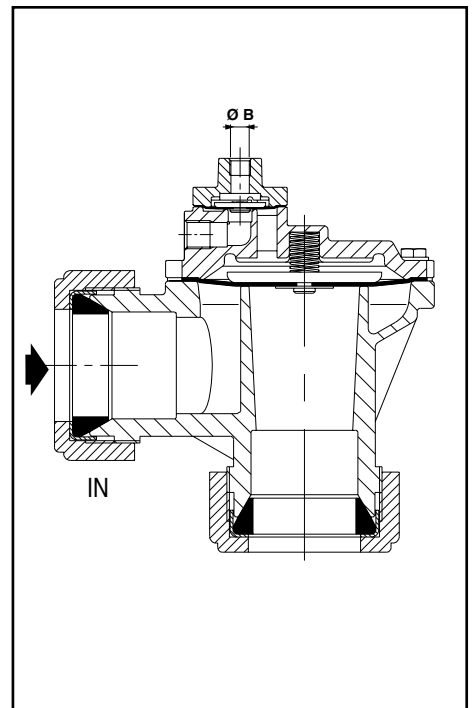

SPECIFICATIONS

pipe size	orifice size	flow coefficient Kv		operating pressure differential (bar)		catalogue number		OPTION FPM
				min.	max. (PS)			
					air			
	(mm)	(m³/h)	(l/min)		~ / =	standard	ATEX II2G/D	
G - Threaded pipe connection								
1 1/2	50	46	768	0,35	8,5	G353A046	G353A046 GD	V
2	66	77	1290	0,35	8,5	G353A048	G353A048 GD	V
2 1/2	66	92	1540	0,35	8,5	G353A049	G353A049 GD	V
Ø - Compression fitting pipe connection								
1 1/2	52	43	717	0,35	8,5	G353A063	G353A063 GD	V

60159GB-2016/R01
Availability, design and specifications are subject to change without notice. All rights reserved.

OPTIONS

- Valves can also be supplied with FPM (fluorelastomer) diaphragms and seal materials. Use the appropriate optional suffix letter for identification
- Sequential controller for pilot solenoid valves
- Pilot boxes containing 2 to 12 pilot solenoid valves
- Pilot solenoid valves can be equipped with explosionproof solenoids for hazardous locations according to "ATEX" and national standards

INSTALLATION

- The valves can be mounted in any position without affecting operation
- Threaded pipe connection is: G = G (ISO 228/1) or compression fittings
- When connecting piping or tubing to the G1/8 or G1/4 connection in the valve bonnet, the remote ASCO pilot valve should be mounted as close as possible to the main pulse valve. Connection tubing lengths of 3 meter or less have little effect on the pulse response. Installations with over 3 meter of tubing must be tested under actual operating conditions. Tubing with Ø 6 or Ø 8 mm O.D. is recommended for all installations
- For compression fitting types tightness is achieved by the compressed gasket on the blow tube
- Other pipe threads are available on request
- Installation/maintenance instructions are included with each valve

SPARE PARTS KITS

catalogue number	Spare parts kit no.
	~/=
G353A046/063 (GD)	C113826
G353A048/049 (GD)	C113684

DIMENSIONS (mm), WEIGHT (kg)

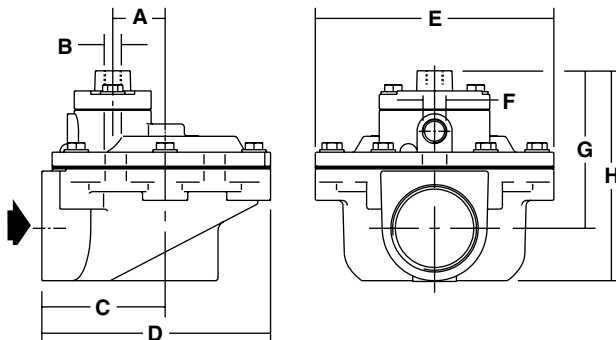

Fig.1 Threaded type

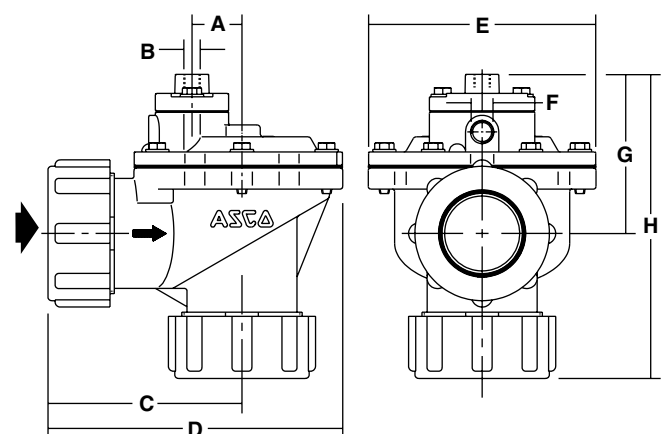

Fig.2 Compression fitting type

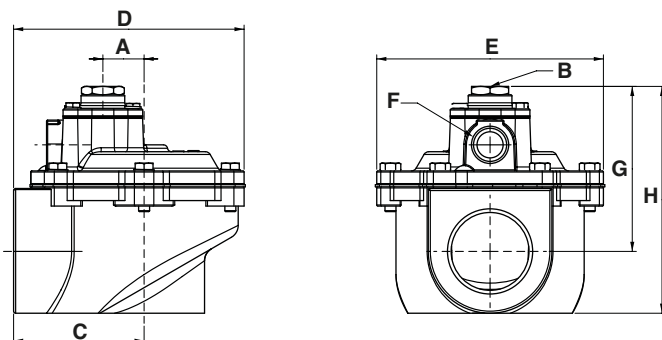

Fig. 3 Threaded type

catalogue number	A	B	C	D	E	F	G	H	weight	(C)
G353A046 (GD)	30	G 1/8"	71	130	136	G 3/8"	90	120	1,10	Abb.1
G353A048 (GD)	30	G 1/4"	95	168	165	G 3/4"	121	166	2,60	Abb.3
G353A049 (GD)	30	G 1/4"	95	168	165	G 3/4"	121	166	2,30	Abb.3
G353A063 (GD)	30	G 1/8"	87	177	136	G 3/8"	96	183	1,43	Abb.2

(C) construction type

All leaflets are available on: www.asconumatics.eu